

front view

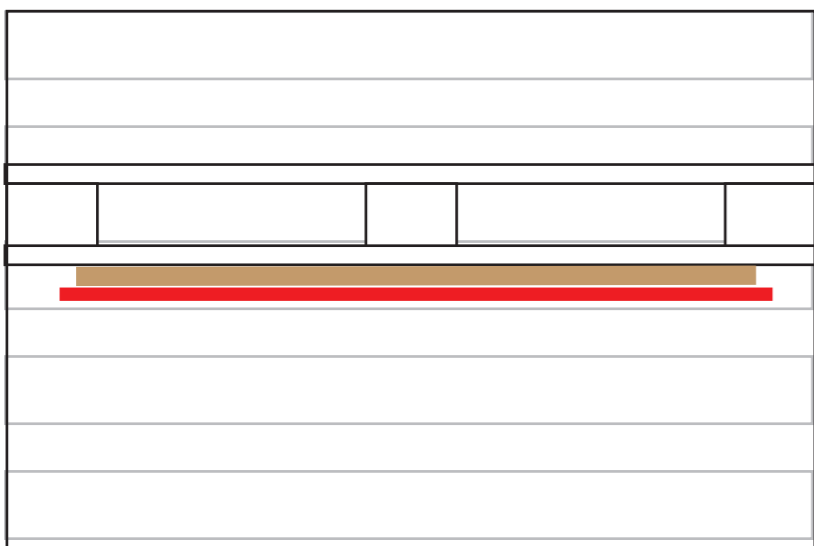

view from above

**MATERIAL LIST:**

- no. 1 Vertical pallet 120x200 cm
- no. 1 Base pallet 120x80 cm
- no. 1 Mobile pallet 160x90cm, cardboard frame with plexiglass panel (90x90cm), wheels
- Cardboard frame with hole 90x90cm
- Homo vitruvian silhouette with red plexiglass vignette
- Cardboard panel (100x100cm) with 120cm diameter plexiglass circle applied on
- Title panel for mobile pallet

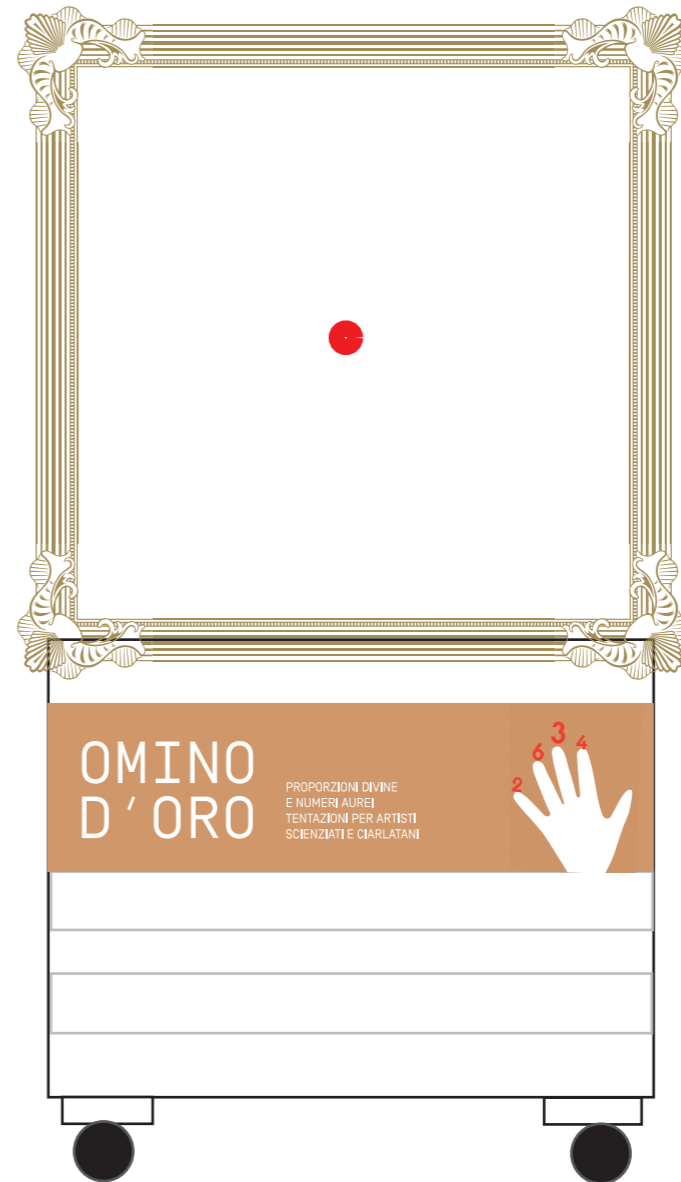

Movable pallet with plexiglass on which to draw with erasable marker, to measure proportions

